

PARTIAL FIFTH FLOOR - FINISH PLAN
1/8" = 1'-0"

Finish Schedule

Contractor must review all specifications and drawings prior to ordering materials and commencing fabrication. Location descriptions are for reference only and are not indicative of every occurrence of a particular finish.
For pricing purposes, assume the same quality level of finishes in all similar types of areas.
See specification section for additional information.

Acoustical Ceilings

As manufactured by ARMSTRONG. Whenever possible, the grids are to be centered in the room on the centerline of the ceiling tile. Install no tile smaller than 6". All ceiling grid to be Armstrong Prelude 15'x16' grid, unless noted otherwise.

- C-1 Style: Metal Works Secure Lock
Size: 24" x 24" x 1 1/2"
Grid: White 15'x16' Prelude
Color: White
NRC: .80
- C-2 Style: Metal Works Secure Lock
Size: 24" x 24" x 5/8"
Grid: 15'x16"
Color: White
NRC: 0.55
- C-3 Gypsum Wallboard Ceilings and/or Soffits
Color: To be determined by interior designer
For use as noted in all toilet rooms and Semi Private Patient Rooms
Note: Soffit floors and underside to be painted same color. Where soffit aligns with adjacent partition, provide 1/2" reveal to accommodate color change.

Paint

Note: All walls to be eggshell finish U.N.O. All Toilet Rooms, Housekeeping, Laundry, Soiled Holding and Clean Linen to be semi gloss. All trim and frames to be semi-gloss finish. Metal access panels to be painted to match adjacent wall or ceiling. All GWB ceilings and soffits to be matte finish unless noted otherwise. Color designations in parenthesis are for reference only refer to specifications.

- PT-1 Color: (White)
For use as general paint and as trim and frame paint.
- PT-2 Color: (Neutral)
For use as accent as noted.
- PT-3 Color: (Purple)
For use as accent as noted.
- PT-4 Color: (Blue)
For use as accent as noted.

Fabric Wrapped Panels

Note: Panels to be wrapped around homotite with square edges.
FWP-1 Pattern: (Stripes)
Color: F25
Width: 50"
For use as fabric wrapped panel at nurse station
Wrapped panels with butt joints.

Wall Protection

- PWP-1 Style: Rigid Vinyl Sheet
Thickness: .040
Texture: Velvet Texture
Note: Installation to begin above noted base
Height: 4'-0"
For use as noted on plan. When noted on plan, for use on all walls.
- PWP-2 Style: IPC Rigid Sheet .040
Thickness: .040
Texture: Non textured finish
Note: For use on all doors throughout scope of work
Doors to be eDoors with stainless steel removable edge

Corner Guards

CG-1 Style: Stainless Steel Flush Mount Corner Guard
Finish: No. 4 Satin Finish
Wing Size: 2"
Thickness: .060"
For use on all outside corners and in all corridors in project area.

Resilient Wall Base

Provide continuous rolls per manufacturer:
RB-1 Style: Cove Base
Size: 4" H (4.37"x7.5")
Note: For use as general base, U.N.O.

Wood Base

WDB-1 Style: Solid white maple with transparent finish
Finish: Clear silicone
Width: 3/4"
Height: 4"
Slat: To match SVT-1
Note: Mechanically fasten base to wall at each stud with tamper resistant screws
For use in each semi private patient room

Plastic Laminate

Note: Color Designations in parenthesis are for reference only
PL-1 Color: (Wood Look-Pear)
For use as vertical surface laminate, U.N.O.
PL-2 Color: (Textured Blue)
For use as vertical laminate as noted on casework elevations

Solid Surface Pattern

- SSP-1 Color: (Neutral)
For use as general solid surface on counters as noted
- SSP-2 NOT USED
- SSP-3 Color: (Beige)
For use in Patient Rooms as noted on drawings
- SSP-4 Color: (Tan)
For use in Toilet rooms for Corian Shower Kit, refer to Specifications.

Quartz Surface

Note: Color Designations in parenthesis are for reference only
QS-1 Color: (Marble Blue)
Thickness: 1.25"
Finish: Polished
For use as horizontal surface as noted on plan

Sheet Rubber Flooring

Provide core web seam installation
Certified Installer Required
Note: Color Designations in parenthesis are for reference only

- SR-1 Style: (Light Tan)
Color: (Light Tan)
Size: 2.0 mm sheet goods
For use as general flooring, U.N.O.
- SR-2 Style: NORAPLAN ENVIRONCARE Art. 1462
Color: (Dark Tan)
Size: 2.0 mm sheet goods
For use as accent flooring
- SR-3 Style: NORAPLAN ENVIRONCARE Art. 1462
Color: (Blue)
Grid: White 15'x16' Prelude
For use as accent as noted
- SR-4 Style: NORAPLAN ENVIRONCARE Art. 1462
Color: (Purple)
Size: 2.0 mm sheet goods
For use as accent as noted
- SR-5 Style: NORAPLAN ENVIRONCARE Art. 1462
Color: (Green)
Size: 2.0 mm sheet goods
For use as accent as noted

Seamless Epoxy

To be used Toilet Rooms and Housekeeping as noted on plans.

- SE-1 Color: (Blue)
Note: Color Designations in parenthesis are for reference only
- SEB-1 Style: Integrate Base
Color: To match SE-1
Height: 6"

Solid Vinyl Tile

- SVT-1 Style: Plank Flooring
Color: (Light Cherry)
Size: 4' x 36"
Thickness: 3mm
For use in Semi Private Rooms
- SVT-2 Style: Plank Flooring
Color: (Dark Cherry)
Size: 4' x 36"
Thickness: 3mm
For use as noted on Finish Plan

Decorative Resin Glazing

Note: Style Designations in parenthesis are for reference only
DRG-1 Style: (Thatch Leaves)
Thickness: 3/8"
Front Finish: Sandstone
Back Finish: Sandstone
For use as noted on finish plan

Phenolic Panel

Note: Color and Style Designations in parenthesis are for reference only

- PP-1 Style: Phenolic Panel
Pattern: (Wood Look)
Color: (Oak)
Thickness: 3/4"
For use at Nurse Station and as noted on drawings
- PP-2 Style: (Metallic Look)
Color: (Aqua)
Thickness: 3/4"
For use at Nurse Station and as noted on drawings
- PP-3 Pattern: (Metallic Look Textured)
Color: (Purple)
Thickness: 3/4"
Height: to 4'-0"
For use as accent as noted on drawings
- PP-4 Style: (Metallic Look)
Color: (Ivory)
Thickness: 3/4"
For use in Patient Rooms as noted on drawings

FINISH GENERAL NOTES

- WHEN AN (A) IS IN THE FINISH TAG IT REFERS TO AN ACCENT FINISH. SEE THE FINISH / FLOOR PATTERN PLANS OR ELEVATIONS FOR TYPE AND LOCATION.
- CORNER GUARDS TO BE INSTALLED ON ALL OUTSIDE CORNERS THROUGHOUT LIMIT OF WORK. SEE FINISH SCHEDULE FOR MORE INFORMATION.
- FLASH PATCH FLOORING AS REQUIRED TO PROVIDE A FLUSH TRANSITION AT ALL DIFFERENT FLOORING MATERIALS.
- ALL GWB SOFFITS ARE TO BE PAINTED. FASCO AND UNDERSIDE ARE TO MATCH. PROVIDE FRY REVEAL REVEALS AS A MATERIAL OR COLOR TRANSITION. GWB SOFFITS ARE NEVER TO RECEIVE VINYL WALL COVERING.
- THE PRIME CONTRACTOR SHALL NOTIFY THE ARCHITECT OF ITEMS REQUIRING FINISH SELECTIONS THAT ARE NOT CLARIFIED IN THE CONTRACT DOCUMENTS.
- CEILING ACCESS PANELS, HVAC DIFFUSERS/GRILLES SHALL BE WHITE UNLESS NOTED OTHERWISE.
- SIGNAGE TO BE PROVIDED BY CONTRACTOR. VA COTR WILL PROVIDE INFORMATION FOR THE SIGNAGE.

INTERIOR FINISH MATERIAL CODES

CODE	MATERIALS
AMP	ARCHITECTURAL WALL PANELS
BG	BUMPER GUARD
CC	CEILING
CCF	CURTAIN FABRIC
CG	CORNER GUARD
CPT	CHARTRAIL
CS	CERAMIC FLOOR TILE
CTB	CERAMIC FLOOR TILE BASE
CWT	CERAMIC TILE
CMTB	DECORATIVE GLAZING
DWS	DECORATIVE WALL SYSTEM
EP	EPOXY PAINT
EM	ENTRANCE MAT
EX	EXISTING
EXP	EXPOSED STRUCTURE
FWC	FABRIC WALL COVERING
FWP	FABRIC WRAPPED PANEL
HR	HAND RAIL
KP	KICK PLATE
PE	POURED EPOXY FLOORING
PEB	POURED EPOXY INTEGRAL BASE
PL	PLASTIC LAMINATE
PT	PANT
PWP	PLASTIC WALL PROTECTION
QS	QUARTZ SLAB
DT	QUARRY TILE
QTB	QUARRY TILE BASE
RB	RUBBER BASE
RD	RUBBER DISC FLOORING
RM	RESILIENT MOLDING
RT	RESILIENT TILE
RST	RUBBER STAIR TREADS
S	STAIN/COLORWASH
SC	SEALED CONCRETE
SCF	SEMI-GLOSS PAINT
SL	SHEET LINOLEUM
SLB	SHEET LINOLEUM BASE
SP	SOLID PLASTIC
SPT	SPECIALTY PAINT COATING
SR	SEAMLESS RUBBER FLOORING
SRT	SOLID RUBBER TILE
SRB	INTEGRAL SEAMLESS RUBBER BASE
SVT	SOLID VINYL TILE
SSP	SOLID SURFACE POLYMER
STN	STONE FLOORING
STNB	STONE FLOOR BASE
SV	SEAMLESS VINYL FLOORING
SVB	INTEGRAL SEAMLESS VINYL BASE
SWVP	SOLID VINYL WOOD PLANKS
TWP	TACKLABLE WALL PANEL
TZ	TERRAZZO FLOORING
V	VINYL WALL COVERING
VB	VINYL BASE
VWF	VINYL BONDED WOOD FLOORING
VCT	VINYL COMPOSITION TILE
WGB	WOOD BASE
WG	WALL GUARD
WM	WOOD MOLDINGS/STANDING AND RUNNING TRIM
WP	WOOD PANELING
WS	WOOD SCIENCE
WT	WINDOW TREATMENT

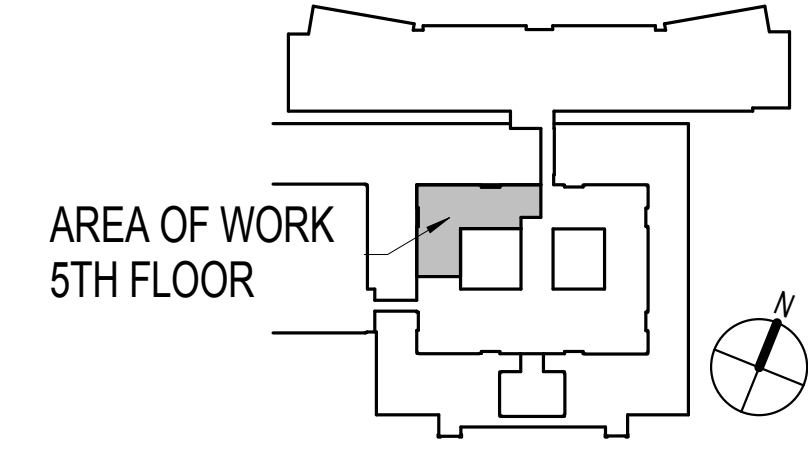

FINAL BID DOCUMENTS APPROVED FOR CONSTRUCTION

CONSULTANTS:		PROJECT MANAGER:		Drawing Title		Project Title		Project Number		Office of Construction and Facilities Management	
ARCHITECT ARRAY Healthcare Facilities Solutions 6800 Broken Sound Parkway NW, Suite 125 Boca Raton, FL 33487 Tel (561) 995-1700 Fax (561) 995-1701	Environmental Engineer AirQuest Environmental, Inc. 5150 SW 48th Way, Suite 610 Fort Lauderdale, FL 33314 Tel (954) 782-4549 Fax (954) 461-7291	Cost Estimator Stover & Associates, Inc. 6800 Broken Sound Parkway NW, Suite 125 Boca Raton, FL 33487 Tel (561) 995-1700 Fax (561) 995-1701	Structural Engineer ONM & J 321 15th Street, Suite 200 West Palm Beach, FL 33401 Tel (561) 635-9994	MEP Engineer Stover & Associates, Inc. 6800 Broken Sound Parkway NW, Suite 125 Boca Raton, FL 33487 Tel (561) 995-1700 Fax (561) 995-1701	STOVER & ASSOCIATES INC. 6800 Broken Sound Parkway NW, Suite 125 Boca Raton, FL 33487 Tel (561) 995-1700 Fax (561) 995-1701	PARTIAL FIFTH FLOOR - FINISH PLAN AND FINISH SCHEDULE		CONSTRUCT PSYCHIATRIC WARD AT 5D CRISIS STABILIZATION UNIT			Building Number 1
Approved: Project Director						Location MALCOM RANDALL VA MEDICAL CENTER		Drawing Number AE105			Date 01/30/12
Revisions		Date		Checked YM/PM		Drawn SS		Dwg. 13 of 68			