

- PARTITION TYPE GENERAL NOTES**
- ALL FIRE RATED AND SMOKE BARRIER PARTITIONS MUST BE INSTALLED PER THEIR UL DESIGN NUMBERS.
 - INSTALL FIRE SEALANT AROUND THE ENTIRE PERIMETER TO PREVENT THE PASSAGE OF SMOKE IN ALL RATED AND SMOKE PARTITIONS.
 - INSTALL SOUND ATTENUATION BLANKET IN ALL PARTITIONS THAT FORM ANY PART OF THE ENCLOSURE OF THE FOLLOWING ROOMS: PATIENT ROOMS, TOILET ROOMS, EXAM ROOMS, TREATMENT ROOMS, OFFICES AND MECHANICAL ROOMS. THESE PARTITIONS SHALL HAVE 5"12" FIBERGLASS BATT SOUND ATTENUATION BLANKETS AND MEET MINIMUM SOUND TRANSMISSION RATING OF STC 45. USE ACCUSTICAL SEALANT AROUND THE ENTIRE PERIMETER ON NON RATED PARTITIONS.
 - REPLACE 5/8" GYPSUM WALLBOARD WITH 5/8" BENS-SHIELD IN ALL AREAS TO RECEIVE CERAMIC TILE. SKIM COAT ENTIRE SURFACE NOT COVER BY TILE.
 - REPLACE 5/8" GYPSUM WALLBOARD WITH 5/8" MOISTURE AND MOLD-RESISTANT GYPSUM WALL BOARD ON ALL PLUMBING WALL OTHER THAN THOSE COVERED IN NOTE # 4 ABOVE.
 - FOR HEIGHTS UP TO AND INCLUDING 14'-0" TYPICAL INTERIOR METAL STUDS ARE 20 GA. AT 16" O.C.; FOR HEIGHTS ABOVE 14'-0" USE 18 GA. AT 16" O.C. USE DOUBLE 2X4 GA. STUDS AT DOORS AND BROWNEED LIGHT FRAMES. USE DOUBLE 18 GA. STUDS AT ICU SLIDING DOORS AND LEAD LINED DOORS AND BORROWED LIGHT FRAMES.
 - NOTIFY ARCHITECT OF WORK TO BE PERFORMED ON EXISTING PARTITIONS AND PROVIDE PRICING ACCORDING TO UNIT PRICES OUTLINED IN SPECIFICATION SECTION 012200.
 - INSTALL SUPPLEMENTARY FRAMING, BLOCKING, AND BRACING IN PARTITIONS TO SUPPORT FIXTURES, EQUIPMENT SERVICES, HEAVY TRIM, GRAB BARS, TOILET ACCESSORIES, DOOR HARDWARE, FURNISHINGS, OR SIMILAR CONSTRUCTION. COMPLY WITH DETAILS INDICATED AND WITH RECOMMENDATIONS OF "GYPSUM CONSTRUCTION HANDBOOK".
 - WHEN INFILLING OR ABUTTING EXISTING PARTITIONS CONTRACTOR TO ADD AN ADDITIONAL LAYER OF GYPSUM WALLBOARD TO PARTITION TYPE AND/OR SKIM COAT WALL AS REQUIRED TO PROVIDE A FLUSH SURFACE. THICKNESS OF GYPSUM WALLBOARD AND / OR STUD SIZE TO BE DETERMINED IN FIELD TO PROVIDE A FLUSH SURFACE.
 - EXTEND ALL WALLS TO UNDERSIDE OF STRUCTURE ABOVE. PROVIDE SLIP TRACK AT TOP OR ANOTHER APPROVED METHOD TO ALLOW FOR A 1" DEFLECTION OF THE STRUCTURE.

- FLOOR PLAN PARTITION GENERAL NOTES**
- ALL PARTITIONS TO BE TYPE 5 UNLESS INDICATED OTHERWISE.
 - ALL CORRIDOR PARTITIONS TO BE TYPE 9 UNLESS INDICATED OTHERWISE.
 - ALL COLUMN ENCLOSURES TO BE PARTITION TYPE 2 UNLESS INDICATED OTHERWISE.
 - THE PARTITION TAG INDICATES THE TYPE OF PARTITION FROM CORNER TO CORNER UNLESS INDICATED OTHERWISE.
 - SEE PARTITION TYPES ON SHEET A601 FOR ADDITIONAL INFORMATION.

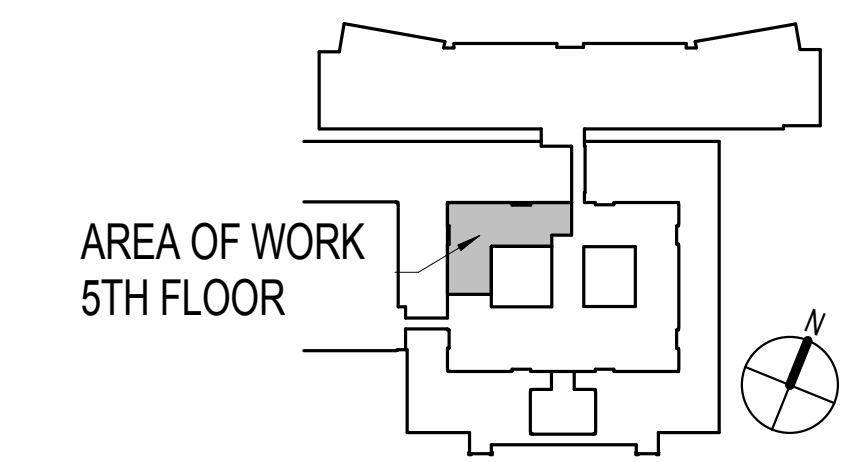

FINAL BID DOCUMENTS APPROVED FOR CONSTRUCTION

CONSULTANTS:

ARCHITECT	Environmental Engineer (Industrial Hygienist)	Cost Estimator	Structural Engineer	MEP Engineer
ARRAY Healthcare Facilities Solutions 6800 Broken Sound Parkway NW, Suite 125 Boca Raton, FL 33487 Tel: (561) 995-1700 Fax: (561) 995-1701	AirQuest Environmental, Inc. 5150 SW 48th Way, Suite 610 Fort Lauderdale, FL 33314 Tel: (954) 782-4549 Fax: (954) 461-2791	Stover & Associates, Inc. 6800 Broken Sound Parkway NW, Suite 125 Boca Raton, FL 33487 Tel: (561) 995-1700 Fax: (561) 995-1701	ONM & J 321 15th Street, Suite 200 West Palm Beach, FL 33401 Tel: (561) 835-9994	Stover & Associates, Inc. 6800 Broken Sound Parkway NW, Suite 125 Boca Raton, FL 33487 Tel: (561) 995-1700 Fax: (561) 995-1701

PROJECT MANAGER:

STOVER & ASSOCIATES INC.

6800 Broken Sound Parkway NW,
Suite 125
Boca Raton, FL 33487
Tel (561) 995-1700
Fax (561) 995-1701

Drawing Title
PARTIAL FIFTH FLOOR - DIMENSION PLAN

Approved: Project Director

Project Title
CONSTRUCT PSYCHIATRIC WARD AT 5D CRISIS STABILIZATION UNIT

Project Number
573-11-120

Building Number
1

Location
MALCOLM RANDALL VA MEDICAL CENTER

Date
01/30/12

Checked
YM/PM

Drawn
SS

Drawing Number
AE102

Dwg. 10 of 68

Office of Construction and Facilities Management

Department of Veterans Affairs

Scale indicators on the left margin:
 three eighths inch = one foot
 one quarter inch = one foot
 one eighth inch = one foot
 one half inch = one foot
 one inch = one foot
 one quarter inch = one foot
 one eighth inch = one foot
 one half inch = one foot
 one inch = one foot